

**BIONIME CORPORATION**

No. 100, Sec. 2, Daqing St., South Dist.,

Taichung City 40242, Taiwan

Tel: +886 4 23692388

Fax: +886 4 22617586

<http://www.bionime.com>

E-mail: info@bionime.com

EC REP

BIONIME GmbH

Tramstrasse 16, 9442 Berneck

Switzerland

E-mail: info@bionime.ch



0197

101-3GM260-032 Rev. Date: 2017-08
EN

GM260

BIONIME
Blood Glucose Monitoring System



USER'S MANUAL

Righttest™ GM260

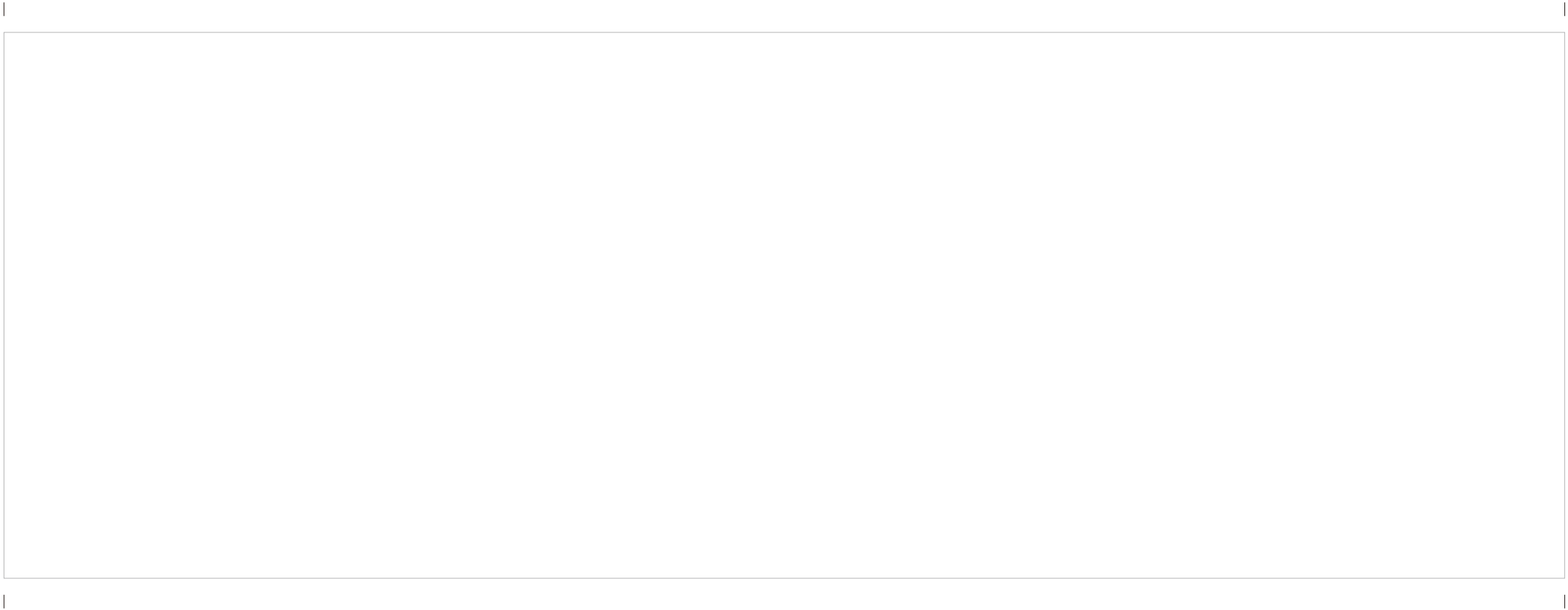

Preface

Thank you for selecting the **Rightest™** Blood Glucose Monitoring System GM260. Please read this manual thoroughly before you start testing. It provides all the information you need to use the product. You will get a correct test result by the following instruction of this manual.

It is quite important for you to monitor blood glucose regularly. A derived complication can thus be effectively reduced. Through the assistance of **Rightest™** Blood Glucose Monitoring system GM260, which provides considerate design and accurate results, your diabetes management can become more reliable and ease-to-use.

The **Rightest™** Blood Glucose Monitoring System GM260 is intended for in vitro diagnostic use (For self-testing) only (outside the body). The testing result is calibrated to be plasma equivalent for test with fresh capillary whole blood samples from the fingertip, palm and forearm. You may consult your healthcare professional for instructions on how to use the system correctly. Our Customer Support staff is available to assist you as well.

The **Rightest™** Blood Glucose Monitoring System GM260 was manufactured and supported by Bionime Corporation and its authorized representative. If you have any questions or concerns, please contact your Bionime authorized representative or email to rightest@bionime.com.

Preface

We will make every effort to provide assistance and solutions for you.

Healthcare professional should be contacted when the authorized representatives are not available.

Please forward your warranty card to Bionime authorized representative to activate your warranty coverage.

Precaution

- Before using the **Rightest™** Blood Glucose Monitoring System GM260 to test your blood glucose, please read all the instructions and practice the tests including quality control test (Refer to P.35).
- Please do the quality control test regularly to make sure the test results are accurate .
- The **Rightest™** Blood Glucose Meter GM260 can only be used with the **Rightest™** Blood Glucose Test Strips GS260. The use of any other brand Strips should not be used under any circumstances. The use of other brands of strips may give inaccurate results.
- The **Rightest™** Blood Glucose Monitoring System GM260 is intended for in vitro diagnostic use only. The testing result is calibrated to be plasma equivalent for test with fresh capillary whole blood samples from the fingertip, palm and forearm.
- The **Rightest™** Blood Glucose Monitoring System GM260 is intended for self-testing. It should not be used to diagnose diabetes mellitus.
- **Rightest™** Blood Glucose Monitoring System GM260 has not been validated for use on neonates. Therefore, it's not intended for use of neonates.
- **Rightest™** Blood Glucose Monitoring System GM260 hasn't been used for arterial blood testing yet, so it is still not suitable to be used for arterial blood testing so far.
- Do the test at least 30 minutes after while entering another site with different ambient temperature.
- Pay attention to the environment protection when disposal of batteries.
- Using appliance in tropical and / or temperate climate.

Precaution

- Not to be exposed dripping or splashing.
- The minimum blood sample size of **Rightest™** Blood Glucose Monitoring System GM260 is 0.75μL (•)

Sample Size Example



Please take a minimum of 0.75μL to do the test on **Rightest™** Blood Glucose Monitoring System GM260. Blood sample size above 3.0μL might contaminate the test strip port and the meter. Blood sample size below 0.75μL might cause inaccurate test result or might not start on meter measurement. In this case, repeat the test with a new test strip.

Table of Contents

About <i>Rightest</i>™ System	
The <i>Rightest</i> ™ Blood Glucose Monitoring System GM260	8
The <i>Rightest</i> ™ Blood Glucose Meter GM260	10
The <i>Rightest</i> ™ Blood Glucose Test Strip GS260	14
Being Ready for Test	
Meter activation and Battery change	16
Setting Up Your Meter - Setting the Time, Volume and Date	18
Turning On/Off the Meter	22
Handling the <i>Rightest</i> ™ Test Strip GS260	23
Testing Procedure	
Getting Ready for Testing	25
Performing a Blood Test	26
View Window Appearance	32
Comprehending Test Results and Messages	33

Table of Contents

Quality Control	
Quality Control Test	35
Performing a Quality Control Test	37
Review Your Test Memory	
Recalling Test Result and Average	39
Caring for Your Meter	42
Error Messages and Trouble Shooting	43
Limitations	48
Specification	49
Customer Service	51
Warranty	52
Main Parts	53

The **Rightest™** Blood Glucose Monitoring System GM260

Package of System Kit

Your **Rightest™** Blood Glucose Monitoring System GM260 consists of several items. Please identify each item of your system and learn what they're called and how they're used.

These items are included in your **Rightest™** Blood Glucose Monitoring System GM260 :

1. Getting Started Guide
2. User's Manual (includes Log Book, Warranty Card, Emergency Card)
3. **Rightest™** Blood Glucose Test Strip GS260 Package Insert *
4. **Rightest™** Control Solution Package Insert *
5. **Rightest™** Blood Glucose Meter GM260 (with 1 CR2032 battery installed)
6. **Rightest™** Blood Glucose Test Strip GS260 (10/25 pcs) *
7. **Rightest™** Control Solution *
8. **Rightest™** Lancing Device GD500 *
9. Clear Cap *
10. Disposable Sterile Lancets (10 pcs) *
11. Carrying Case (not shown) *
12. Instruction for the lancing device (not shown) *

(Different packages have different bundled items. Some of packages might not include * items.)

The **Rightest™** Blood Glucose Monitoring System GM260

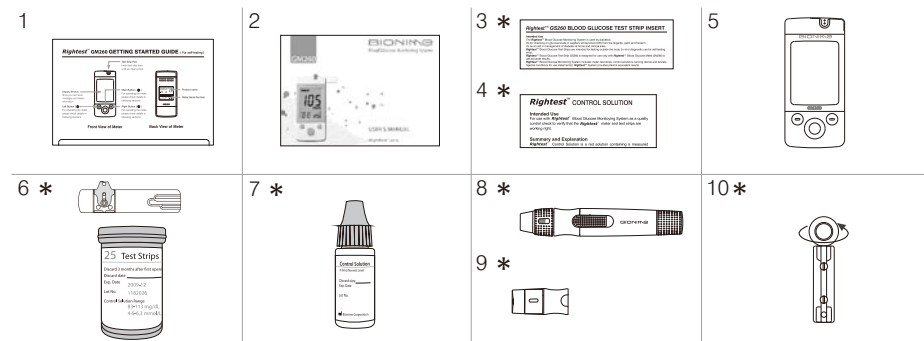

***The Rightest™* Blood Glucose Meter GM260**

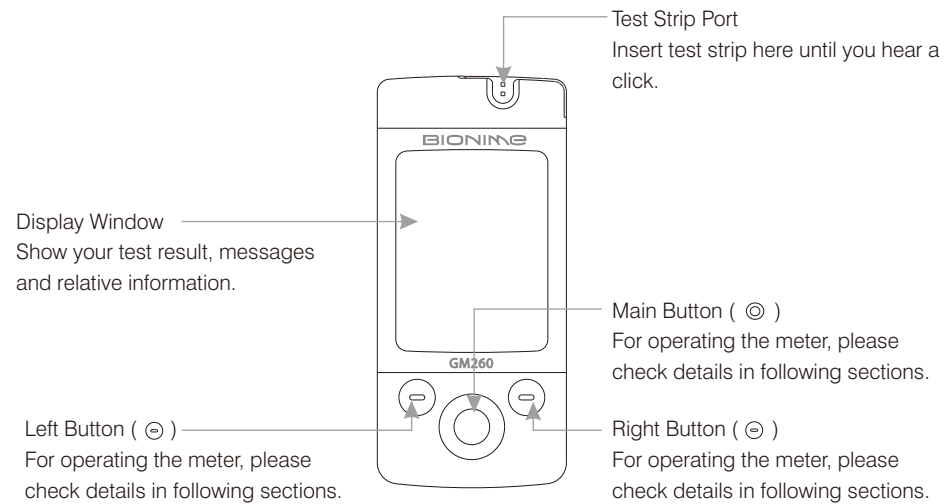



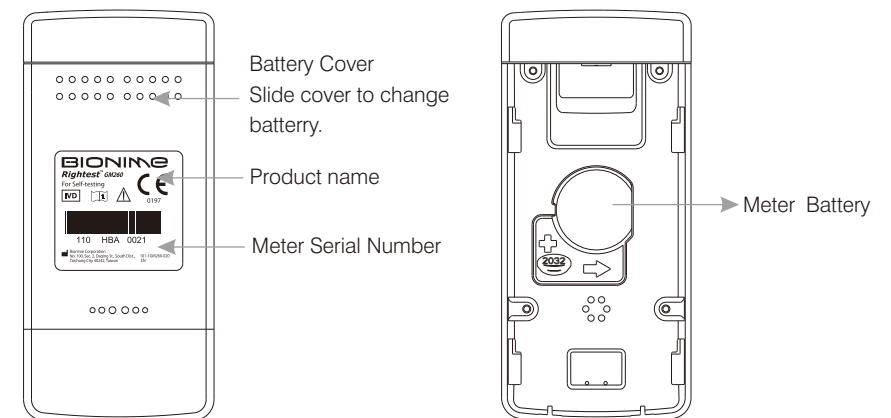

***The Rightest™* Blood Glucose Meter GM260**

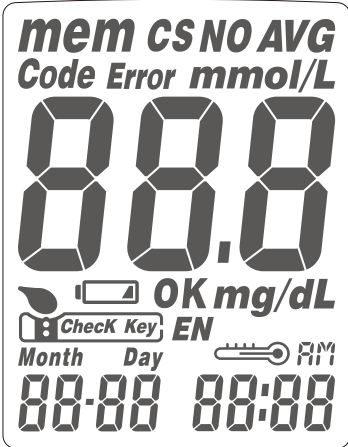

The Rightest™ Blood Glucose Meter GM260



The Rightest™ Blood Glucose Meter GM260

mem	Indicates a test result stored in memory		Tell when to apply the blood sample
NO AVG	Indicates a test result, not joining into the Average function of this meter		Appears after you insert test strip into meter
AVG	Indicates with the average result	Error	Appears when an error occurs
CS	Indicates a control solution test result	Month Day 88-88	Current date under time mode or Testing date under memory mode
mmol/L mg/dL	Unit of test result		Indicates if the environmental temperature is exceeded during testing
88.8	Test result	AM	Indicates the time in 12H format
	Warns when the battery is low or must be replaced	88:88	Current time under time mode or Testing time under memory mode
OK EN Check Key Code Manufacturing use only			

The **Rightest**™ Blood Glucose Test Strip GS260

The **Rightest**™ Blood Glucose Meter GM260 can only be used with the **Rightest**™ Blood Glucose Test Strips GS260.

The application of other Test Strips or control solutions can lead to incorrect results.

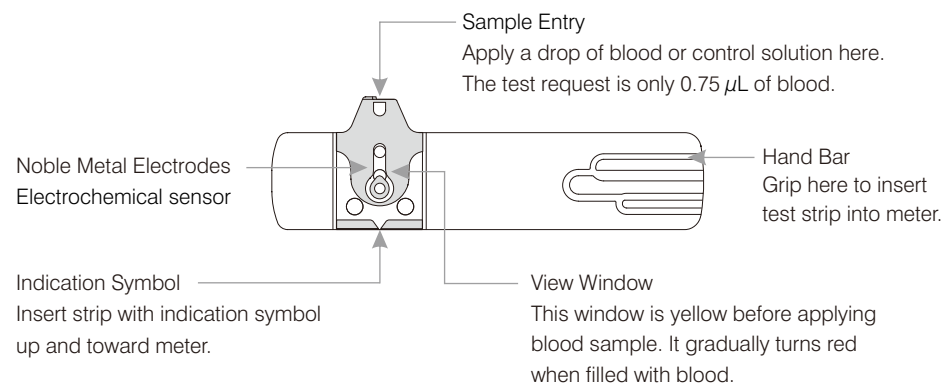

The **Rightest**™ Blood Glucose Test Strip GS260

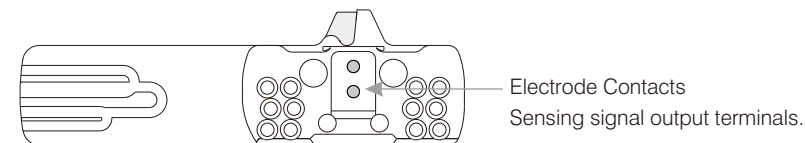

PRECAUTION

- Re-cap the **Rightest**™ Blood Glucose Test Strip GS260 vial immediately after taking out a test strip.
- Do not reuse **Rightest**™ Blood Glucose Test Strip GS260.
- Do not use expired **Rightest**™ Blood Glucose Test Strip GS260.
- Record the date of opening a new **Rightest**™ Blood Glucose Test Strip GS260 vial for the first time. Discard the vial of test strips after 3 month from opening.
- Store the **Rightest**™ Blood Glucose Test Strip GS260 in a cool (39-86°F or 4-30°C) and dry location (< 90% relative humidity). Do not expose to direct sunlight or heat.
- For detailed information, please refer to the **Rightest**™ Blood Glucose Test Strip GS260 Package Insert.
- If the **Rightest**™ Blood Glucose Meter GM260 and Test Strips GS260 are exposed to a high temperature difference, please wait 30 minutes before measurement.

Meter activation and Battery change

Your **Rightest™** Blood Glucose Meter GM260 comes with one CR2032, 3volt, battery installed. One new battery will provide power to perform about 1000 tests under normal use. You can press the main button or insert a strip to activate your meter.

Meter activation and Battery Change

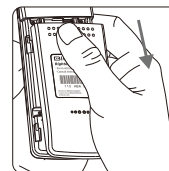

1. Turn the **Rightest™** Blood Glucose Meter GM260 over. Press and push battery cover to open.

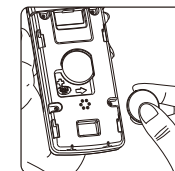

2. Install the battery. Be sure to put battery in correct direction.

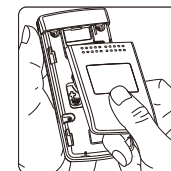

3. Slide the battery cover back until it snaps into place.

4. The **Rightest™** Blood Glucose Meter GM260 performs a self test.

5. Press any button to exit the self-test and enter Setting Mode.

6. Set the time and date when the batteries are replaced. See Chapter "Setting up your meter - setting the time, volume and date". Test results are still stored in the memory.



PRECAUTION

- Please follow the local regulation and discard a used battery properly.

Setting Up Your Meter- Setting the Time, Volume and Date

You can enter Setting Mode by the following two ways.

1. Reload battery

After removing the battery, please press the main button for several times until no signal on screen, then follow the battery installation steps to load battery. The **Rightest™** Blood Glucose Meter GM260 will do self test. Press the main button to exit the self test and enter Setting Mode.

2. Press the Main button

Press the main button to turn on the **Rightest™** Blood Glucose Meter GM260. Then press and hold the main button for 7 seconds until you hear a beep, indicating you have successfully entered Setting Mode. The display screen will show setting data.

NOTE

- When you keep pressing the main button for 3 seconds, the display on screen will turn off. Please don't care it. Keep pressing the main button till entering setting data.
- Quick press the main button allows you to change setting. However, if you want to return to the time mode, you need to go through all the settings first by pressing quickly the main button.

Setting Up Your Meter- Setting the Time, Volume and Date

1. Year setting

With the year format blinking, press the Left or Right button to adjust it. Then press the Main button to confirm it. Then it will move to Month setting.

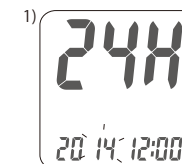

2. Month setting

With the month blinking, press the Left or Right button until the current month appears. Then press the Main button to confirm it and move to Day setting.

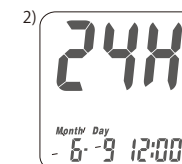

3. Day setting

With the day blinking, press the Left or Right button until the current day appears. Then press the Main button to confirm it and move to Time format setting.

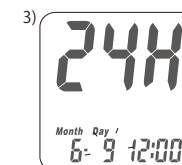

Setting Up Your Meter- Setting the Time, Volume and Date

4. Time format 12/24H selection

With the time format blinking, press the Left or Right button to adjust it. Then press the Main button to confirm it and move to hour setting.

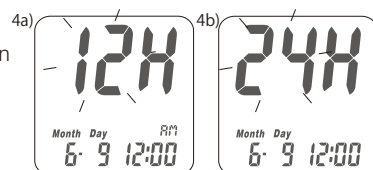

5. Hour setting

With the hour blinking, press the Left or Right button until the current hour appears. Then press the Main button to confirm it and move to minute setting.

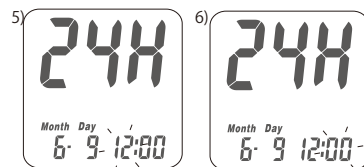

6. Minute setting

With the minute blinking, press the Left or Right button to adjust it. Then press the Main button to confirm it. Then it will move to volume setting.

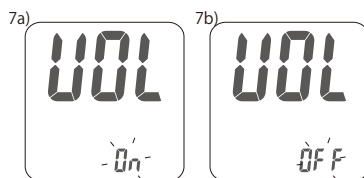

7. Volume setting

With the volume blinking, press the Left or Right button to turn it on or off. Then press the Main button to confirm and move to measurement of unit setting.

Setting Up Your Meter- Setting the Time, Volume and Date

8. Setting the Unit of Measurement

With milligrams per deciliter(mg/dL) or millimoles per liter (mmol/L) blinking, press the Left or Right button to switch. Then press the main button to confirm it and finish the settings.

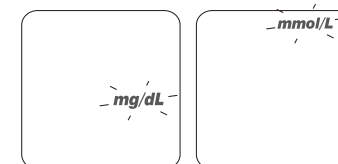

9. Ending setting

After measurement of unit settings, for confirmation you will hear a beep (if volume is turned on). All the settings are saved and completed and will return to time screen. (If Volume is turned off, the display will directly return to time screen without a sound of "beep".)



NOTE

- When you do not do any settings of meter for over 2 minutes, the **Rightest™** Blood Glucose Meter GM260 will leave setting mode and power off automatically.
- Your **Rightest™** Meter GM260 is ready to use at the first time. The meter default is set according to your local preference.

Turning On/Off the Meter

1. How to turn on the **Rightest™** Blood Glucose Meter GM260
Press the Main button or insert a test strip.
2. Manual Power off
If you want to turn off the **Rightest™** Blood Glucose Meter GM260, please keep pressing the Main button for 3 seconds.
3. Auto Power off
The **Rightest™** Blood Glucose Meter GM260 will power off automatically if you don't operate it over 2 minutes.

Handling the **Rightest™** Test Strip GS260

How to handle the **Rightest™** Blood Glucose Test Strip GS260?

Inserting the **Rightest™** Blood Glucose Test Strip GS260:

1. Hold the **Rightest™** Blood Glucose Test Strip GS260 between thumb and middle finger with indication symbol "  " facing up.
2. Put forefinger on the side of strip as shown.



NOTE

This is the easiest way to insert the strip.

3. Insert the **Rightest™** Blood Glucose Test Strip GS260 into test strip port until it snaps and firmly stops.

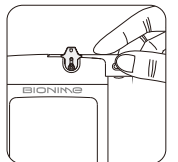
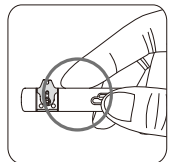
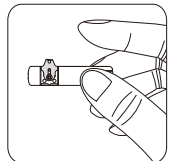

Handling the **Rightest™** Test Strip GS260

Removing the **Rightest™** Blood Glucose Test Strip GS260:

1. Hold the **Rightest™** Blood Glucose Test Strip GS260 same as insert it.

2. Rotate the **Rightest™** Blood Glucose Test Strip GS260 counterclockwise and pull up at the same time.

NOTE

Pulling the strip in a counterclockwise direction will make it easier to remove it from the meter.

3. Take the **Rightest™** Blood Glucose Test Strip GS260 out of test strip port totally.

Please follow the local regulation and discard used strip properly.

NOTE

Test Strip Port will not be contaminated by blood, if you follow the step correctly.

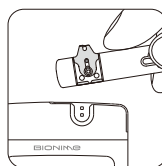
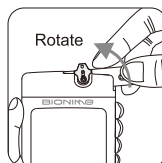
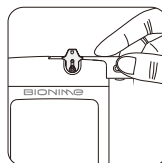

Before performing a blood glucose test, you have to prepare the items below :

- **Rightest™** Blood Glucose Meter GM260
- **Rightest™** Blood Glucose Test Strips GS260
(Please check the expired date on the vial. Don't use the expired test strip)
- **Rightest™** Lancing device GD500
- Sterile lancet
- Alcohol swab (optional)

Getting Ready for Testing

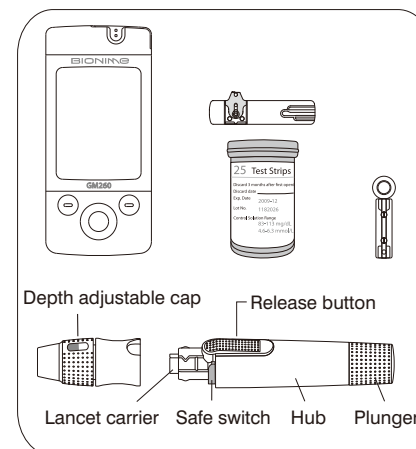

Performing a Blood Test

1. Hold the adjustable cap in one hand and hold the hub in the other hand.
Bend the cap towards the down side. When a gap appears between the cap and hub, pull them off in opposite directions.

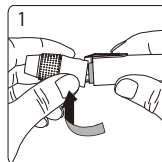

2. Pull off the depth adjustable cap.
3. Insert a new disposable lancet firmly into lancet carrier.

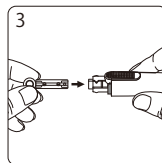
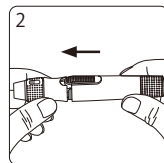

4. Twist off and set aside the protective cover of the disposable lancet.

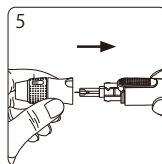
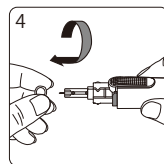

5. Replace the depth adjustable cap.

26

Performing a Blood Test

6. Choose a depth of penetration by rotating the top portion of the depth adjustable cap until the setting depth matches the window. Settings are based on skin type "1" for soft or thin skin; "2" for average skin; "3" for thick or calloused skin.

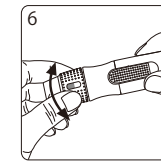

7. Hold the hub in one hand and pull on the plunger in the other hand. The device will be cocked. Release the plunger, it will automatically move back to its original position near the hub.
8. Wash your hands with warm soapy water and dry thoroughly.
9. Take one **Rightest™** Blood Glucose Test Strip GS260 from the vial. Re-cap the vial cap immediately.
10. Insert the strip into the strip port of the **Rightest™** Blood Glucose Meter GM260 with the indication symbol facing up. The meter confirms the insertion of the strip with a beep (if volume is turned on).

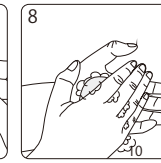
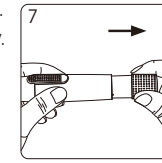

NOTE
The **Rightest™** Blood Glucose Meter GM260 will automatically detect Code number on strip. You don't have to check the Code number on the meter display and strip vial.

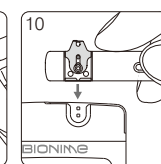
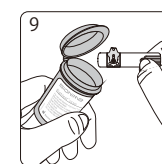

27

Performing a Blood Test

11. A blood drop symbol appears and is accompanied by a further beep (if volume is turned on). Now you can apply the blood sample within 2 minutes.
12. Place the lancing device against your fingertip and press the release button.
13. Touch and hold the drop to the edge of sample entry until you hear a "beep" (if volume is turned on) and the View Window is totally filled with blood. If the View Window is not totally filled with blood or the test does not start, please discard the test strip and repeat the test with a new **Rightest™** Blood Glucose Test Strip GS260.
14. You will see the countdown mode on the screen. After 5 seconds, the test result appears.

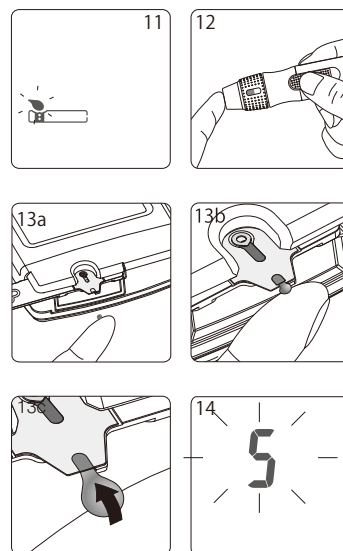

Performing a Blood Test

15. Pull off the depth adjustable cap. Without touching the used disposable lancet, stick the lancet tip into the protective cover.
16. Holding the release button in one hand (see picture 16, step 1) and pulling on the plunger in the other hand (see picture 16, step 2) will safely eject the used disposable lancet.
17. Discard the used disposable lancet into an appropriate puncture-proof or biohazard container.
18. Replace the depth adjustable cap after finishing the test.

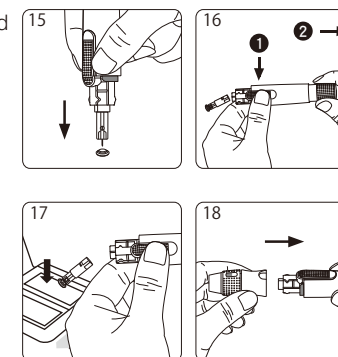

- PRECAUTION**
- Do not apply your blood drop to the sample entry on the strip until you see the " " appear. The **Rightest™** Blood Glucose Meter GM260 is performing an internal test and will display " " and " **Error** " if you apply blood too soon. Please repeat the test with a new **Rightest™** Blood Glucose Test Strip GS260.
 - Record the date of opening a new **Rightest™** Blood Glucose Test Strip GS260 vial for the first time. Discard the vial of test strips after 3 months from opening.

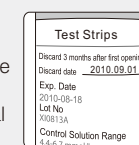

Performing a Test in Order

Alternative site testing-palm or forearm blood sampling

- To do the alternative site testing, please install the clear cap for your **Rightest™** Lancing Device GD500. (For detailed information of lancing device, please check the instruction manual for the **Rightest™** Lancing Device GD500.)
- To increase the blood flow, please massage the puncture area of palm or forearm for a few seconds.
- Immediately after massaging the puncture area, press and hold the lancing device with the clear cap against palm or forearm.
- Then press the release button.
- Continue holding the lancing device against palm or forearm and gradually increase pressure for a few seconds until the blood sample size is sufficient.

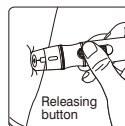
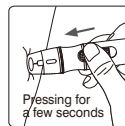
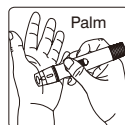

Performing a Test in Order



PRECAUTION

- The glucose test results of blood samples taken from different sites might be varied in certain conditions such as your glucose is changing rapidly following a drink, a meal, an insulin dose or exercise. In these cases, only fingertip should be used.
- DO NOT test on the palm or forearm if you are testing for hypoglycemia (Low blood glucose).
- Fingertip samples can show the rapid change of glucose faster than palm or forearm samples.
- Consult with your healthcare professionals whenever you want to conduct a sampler from palm or forearm.
- As the blood flow taken from forearm is slower than fingertip or palm, we recommend using a special lancing device with Clear Cap for testing sites other than finger.
- If you use normal lancing device for palm or forearm the blood sample might be not enough for meter.
- Please periodically compare the test system to a laboratory test system known to be well maintained and monitored by a healthcare provider.

View Window Appearance

Make sure your blood sample covers the whole area of the View Window to get an accurate test result. Insufficient blood sample might cause inaccurate test result. Repeat the test with a new test strip.

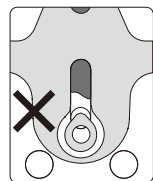

Insufficient blood sample

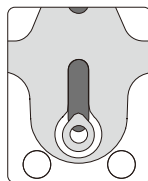

Enough blood sample

Comprehending Test Results and Messages

If your blood glucose result is unusually high or low, or if you question your testing results, repeat the test with a new **Rightest™** Blood Glucose Test Strip GS260. You can also run a QUALITY CONTROL TEST with your **Rightest™** Control Solutions to check your **Rightest™** Blood Glucose Meter GM260 and Test Strip GS260 (Refer to P. 35). If the test result still remains unusually high or low, contact your healthcare professional immediately.

If you are experiencing symptoms that are not consistent with your blood glucose test results and you have made sure to follow all instructions of this manual, contact your healthcare professional immediately.

PRECAUTION

- Check the expiration date printed on the package every time you use the strip. Do not use expired **Rightest™** Blood Glucose Test Strip GS260.
- Use each **Rightest™** Blood Glucose Test Strip GS260 immediately after taking it out from the vial.
- Do not reuse **Rightest™** Blood Glucose Test Strip GS260.
- Do the test at least 30 minutes after while entering another site with different ambient temperature.

Comprehending Test Results and Messages

The **Rightest™** Blood Glucose Meter GM260 displays results between 10 and 600 mg/dL. If your test result is below 10 mg/dL, "Lo" will appear on the screen. Please repeat your test again by a new strip. If you still get "Lo" result, you should immediately contact your healthcare professional.

If your test result is above the high end of the system's detective range (600 mg/dL), "Hi" will appear on the screen. Please repeat your test again by a new strip. If you still get "Hi" result, you should immediately contact your healthcare professional.

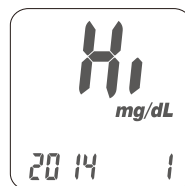
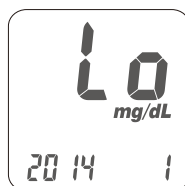

Quality Control Test

Please use **Rightest™** Control Solution tested with **Rightest™** Blood Glucose Monitoring System GM260 under Control Solution Mode. If the test result is within the Control Solution Range printed on the strip vial label, the **Rightest™** Blood Glucose Monitoring System GM260 passes Quality Control Test. That means your **Rightest™** Blood Glucose Monitoring System GM260 is working correctly.

Control Solution Range:

Example of Control Solution Range printed on your test strip vial label.

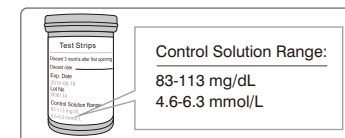

When should a Quality Control Test be performed ?

- To ensure that your **Rightest™** Blood Glucose Meter GM260 and Test Strip GS260 are working together properly.
- To confirm that you are following the correct procedure.
- To prepare for your initial blood glucose test.
- To check the **Rightest™** Blood Glucose Test Strip GS260 when you open a new vial of strips.
- To check your **Rightest™** Blood Glucose Meter GM260 after it has been dropped, damaged or exposed to liquids.
- When you suspect that your test results are inaccurate, or if your test results are not consistent with the way you feel.

Quality Control Test



NOTE

- If you want to purchase new **Rightest™** Control Solution, please contact your authorized Bionime representative.

The possible reasons your Control Solution results are out of the range :

- Your **Rightest™** Control Solution has expired or has been opened 3 months ago.
- Your **Rightest™** Blood Glucose Test Strip GS260 has expired.
- You left the cap of the **Rightest™** Blood Glucose Test Strip GS260 vial opened or the **Rightest™** Control Solution off for a long time.
- You didn't perform the test procedure correctly.
- Malfunction of the **Rightest™** Blood Glucose Meter GM260 or Test Strip GS260.

If Control Solution results are out of range, your **Rightest™** Blood Glucose Monitoring System GM260 may not be working properly. Repeat the Quality Control Test. If your Control Solution results outside the range still exist, do not use the Blood Glucose Monitoring System GM260 to test your blood glucose and contact your Bionime Customer service.

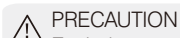

PRECAUTION

Each time you open a new bottle of **Rightest™** Control Solution, write the discard date on the label. **Rightest™** Control Solution is good for 3 months after opening the bottle, or until the expiration date printed on the label, whichever comes first.

Example of Expiration Date:



Performing a Quality Control Test

1. Take one **Rightest™** Blood Glucose Test Strip GS260 from vial and re-cap the vial cap immediately.
2. Insert the **Rightest™** Blood Glucose Test Strip GS260 with view window, facing up, into test strip port.
3. While the blood drop symbol flashing, press and hold the main button for over 3 seconds until the "CS" symbol appears.
4. You will see blinking "CS" symbol and "CS" symbol on the screen, prompting you to apply **Rightest™** Control Solution.
5. Shake the bottle of **Rightest™** Control Solution well before opening the cap. Then open the bottle and put the cap on the table.
6. Drip a drop of **Rightest™** Control Solution on the top of the cap.
7. Gently touch sample entry of the strip with the **Rightest™** Control Solution on the top of the cap.
8. When you hear a beep (if volume is turned on) please wait for the test result. The screen will display the countdown number from 5.

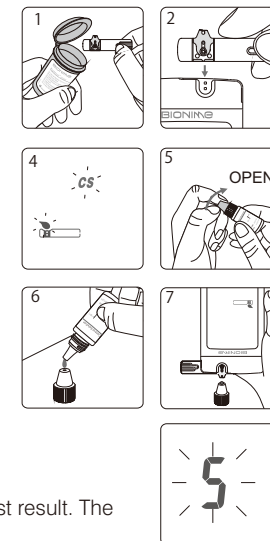

Performing a Quality Control Test

9. Tightly replace the cap on the **Rightest™** Control Solution bottle.
10. The Control Solution result appears. Compare your Quality Control Test result to the Control Solution Range printed on the **Rightest™** Blood Glucose Test Strip GS260 vial label.

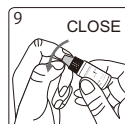

⚠ PRECAUTION

- Your Control Solution results will not be calculated for average reading but still can be recalled. The Control Solution Test result will be shown with "CS" symbol on the screen.
- Our suggestion environment for Control Solution Test is 59-104°F (15-40°C).
- Before "☹" and "CS" appears, please don't touch the **Rightest™** Control Solution to the sample entry on strip because the **Rightest™** Blood Glucose Meter GM260 is still in an internal check. If you do so, the meter will show "☹" and "Error". Accompanied by beeps (if volume is turned on).
- Don't drip the **Rightest™** Control Solution to sample entry of the strip directly. The reagent on strip might be sucked into the bottle of **Rightest™** Control Solution and might cause the degeneration of **Rightest™** Control Solution. Doing this might contaminate the meter via the test strip port as well.
- Don't touch the tip of the **Rightest™** Control Solution bottle. If you have touched it, please clean up with water.



Recalling Test Result and Average

The **Rightest™** Blood Glucose Meter GM260 is able to store 500 test results with time and date automatically. If your meter has stored 500 results, which is the maximum memory of the meter, the newest test result will replace the oldest one. To recall your test memory, start the meter without test strip inserted.

1. Press the Main button to switch from the Time mode to the Memory mode. First you will see the "MEM" symbol on the upper left corner of the display. When you press the right button, the latest result will be displayed. By pressing the right button sequentially former test results will be shown in historical order. You will see the sequence number on the lower right corner and the year on the lower left corner of the display followed by date and time of the measurement.

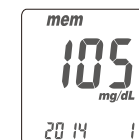

Note: The Right button is for reviewing the tests with sequence number increasing, and the Left button is for reviewing tests with sequence number decreasing. The sequence no "1" is the latest result while sequence no "500" is the oldest test result.

2. To finish reviewing memory tests, press Main button again, and you will enter the Average screen. By pressing the Right button, the display shows "AVG" on the upper right corner of the display and the average value for the actual day. By sequentially pressing the Right or Left button you will get to the 1-day, 14-day, 30-day and 90-day average of your blood glucose values. You will see the number of the calculated days on the lower left corner and the number of the calculated readings on the lower right corner.

Recalling Test Result and Average

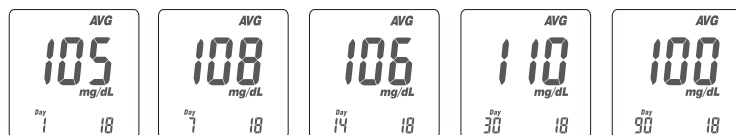

3. Non-Averaging set and canceled:

You may select the unwanted or doubtful test results, to exclude them from the average calculation, after your every test. After you finished your test in the test mode, you can exclude the unwanted result. Keep pressing the Right button until you see the symbol "NO AVG" in the top right corner of the screen. By keeping the Right button pressed and pressing the main button simultaneously to confirm the value as "Non average". Now this value is flagged by the symbol "NO AVG" in the upper right corner of the screen. If you want to cancel this non-averaging setting, you have to stay in the test mode. First keep pressing the Right button until the "NO AVG" symbol changes to "AVG" in the upper right corner of the screen. To confirm this original status you again simultaneously press the Main button to confirm the "AVG" status. Now the value will be stored as a regular value and included in the average values.



NOTE

- The average function is related to the time setting. You must set the time right and have enough time intervals on the basis of current inquiry time, to make sure that the average test results will show. Use the 14-day average for example; if your current inquiry time is 2010/1/30, then that you must check that you have tested blood glucose in the past 14 days before 1/30, including today. If not, the 14-day average will show no figure.
- The Non-averaging/re-averaging function only works in the test mode and when you get the value. In the MEM mode, you can not perform this action.

Recalling Test Result and Average

4. Quick Searching: If you want to see all values automatically displayed in sequence, first enter the memory mode. Then keep pressing the Right or Left button for 2 seconds. (Right button is for searching the tests the latest value to the oldest one; by using the Left button you can scroll from the oldest to the latest one). Anytime you want to stop just release the pressed button. It will stop and display the current displayed value. You can use this way to find a particular reading you want to check.

5. Reading right after test: If you just finish the test, press the Main button to enter the MEM (memory) screen and review the latest test result.



NOTE

Your Control Solution results will be automatically non-averaged without selecting, but still can be recalled. The Control Solution Test results will show with "CS" symbol under memory screen.



PRECAUTION

- You have to set the time and date to activate the average function.
- The "Lo", "Hi" results, the Control Solution results and the test result made out of normal temperature range <50°F (10°C), >104°F (40°C) are not calculated in the average.

Caring for Your Meter

Maintenance

Keep your **Rightest™** Blood Glucose Meter GM260 and Test Strip GS260 free of dust, water or any other liquid. Store the meter in the carrying case when not in use. If meter is dropped or damaged, perform a quality control test with the control solution before doing a blood glucose test.

Cleaning Meter

Clean the outside of the **Rightest™** Blood Glucose Meter GM260 with a damp cloth and mild soap/detergent. Keep the test strip port from getting wet.

Cleaning Test Strip Port

If your Test Strip Port is stained with blood, control solution or any liquid, please use a dry tissue or alcohol swab to clean it up immediately. Do not use any thing wet to clean it. Perform a quality control test to ensure the **Rightest™** Blood Glucose Meter GM260 is working properly.

Error messages and Trouble shooting

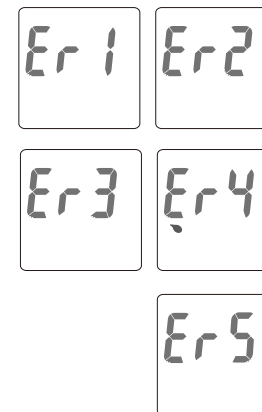

- Er1 - The inserted test strip has been used or damaged. Please use a new test strip from vial.
- Er2 - Meter has malfunctioned. Do the Quality Control Test or reinstall the battery to check if the meter works properly.
- Er3 - Signal transmission is disrupted, repeat the test.
- Er4 - Applied blood volume is insufficient, repeat the test with a new test strip.
- Er5- An issue calibrating the Meter has occurred. Please follow the steps below:
1. Remove the test strip from the meter.
 2. Turn off the meter(press and hold the Main button for 3 seconds).
 3. Press the main button to turn ON the meter.
- If after turning on the Meter, you do not see Er5, your meter is functioning properly and able to perform a test.





If one of the above error messages still appears, please contact your Bionime authorized representative or email to rightest@bionime.com.

Error messages and Trouble shooting

Battery Error

1. The "  " symbol is blinking when the battery power is low. Please change the meter battery as soon as you can. You can still do the test.
2. The "  " and " **Error** " symbols are blinking when the battery is too low. Meter is unable to perform a normal test. Please change the battery immediately.

Strip Error

1. When the test strip is inserted incorrectly, the meter will beep 4 times while the "  " symbol flashes. Do not apply a sample on the test strip. Please re-insert the unused test strip correctly (refer to "Handling the **Rightest**[™] GS260 Blood Glucose Test Strip" on P.23 for more information).
2. If, after performing the required steps, the "  " and flashing " **Error** " symbols appear on the screen, it means the **Rightest**[™] GS260 Test strip has been inserted incorrectly more than twice. Please, re-insert the unused test strip again after reviewing the steps on how to insert a test strip correctly on P.23 or call Customer Service for support. This error message can also indicate that you may have used the wrong test strips. Please check the test strip vial to ensure you are using the **Rightest**[™] GS260 Test strips.

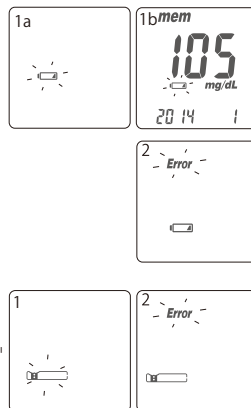

Error messages and Trouble shooting

⚠ CAUTION

A blood sample should **ONLY** be applied to the test strip after the test strip has been inserted correctly and the Meter's screen is showing the image of the test strip and a blood drop flashing symbol. If the blood drop flashing symbol is **NOT** showing on the screen, do not apply a sample to the test strip. Please re-insert the unused test strip correctly. The screen **MUST** show the image of the test strip accompanied by the blood drop symbol flashing (this symbol take 3 seconds to show after correctly inserting the test strip) in order for a sample to be applied. Please consult your User Manual and/or contact Customer Service for support on how to correctly insert a **Rightest**[™] GS260 Test strip.

Error messages and Trouble shooting

Temperature Error

In order to get accurate test result, perform a test between 50~104°F (10~40°C).

1. When the ambient temperature is 32~49°F (0~9°C) or 105~122°F (41~50°C) the " " warning symbol will be blinking (1a), you still can do the test but the test result is only for reference, because the test result under these ranges of temperature might not be correct. In the memory screen this value will be flagged with " " symbol (1b). Repeat the test at an area with temperature between operating range (50~104°F or 10~40°C).
2. When you move from the area with temperature outside the operating range of test strip to another area with temperature inside operating range of test strip, please wait for 30 minutes before you do the test.
3. When the temperature is below 32°F (0°C) or over 122°F (50°C), **Rightest™** Blood Glucose Meter GM260 can not do the test and the " **Error** " symbol will blink with thermograph symbol displaying on screen in this condition. Please move the meter to environment with temperature between 50~104°F (10~40°C) and repeat the test after 30 minutes.

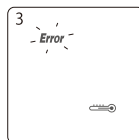
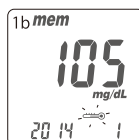
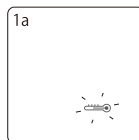

Error messages and Trouble shooting

Sampling Error

Please don't apply the blood drop to the sample entry of the strip before the

Rightest™ Blood Glucose Meter GM260 displays " " . If you do so, the meter will display " **Error** " and " " accompanied by beeps (if volume is turned on). Please discard the test strip and repeat the test with a new **Rightest™** Blood Glucose Test Strip GS260.

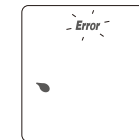

Meter Malfunction

If the **Rightest™** Blood Glucose Meter GM260 can not be started, please follow the steps below:

1. Open the battery cover, remove the battery.
2. Wait for 5 minutes and insert the battery as described "Meter activation and Battery change" on P.16~17.

The **Rightest™** Blood Glucose Meter GM260 should be working normally after finishing above steps. If not, please contact your local Bionime customer service.

Limitations

- Store the **Rightest™** Blood Glucose Test Strips GS260 in the original capped vial at temperatures between 39°F to 86°F (4°C to 30°C) and relative humidity below 90%. Do not freeze.
- **Rightest™** Blood Glucose Test Strips GS260 are designed for using with capillary whole blood samples. Do not use serum or plasma samples.
- Inaccurate test results may be obtained at high altitude more than about 10000 feet (3048 meters) above sea level.
- Hematocrit below 30% may cause higher results, and hematocrit above 60% may cause lower results.
- Severe dehydration and excessive water loss may cause inaccurately low results.
- **Rightest™** Blood Glucose Monitoring System GM260 has not been validated for use on neonates.
- The glucose test may be interfered under abnormal concentration of
Uric acid ≥ 16.0 mg/dL (≥ 0.96 mmol/L)



NOTE

- Acetaminophen, Ascorbic acid (Vitamin C), Dopamin, Ibuprofen, Methyldopa, L-Dopa, Salicylic Acid, Tetracycline, Tolbutamide, Bilirubin-unconjugated, Cholesterol, Creatinine, Triglyceride, Maltose, Xylose, Galactose and Lactose (when occurring in normal blood or normal therapeutic concentrations) do not significantly affect results. However, abnormally high concentrations in blood may cause inaccurate results.
- Sodium Fluoride/Potassium Oxalate at low glucose levels may result in inaccurate blood glucose reading. Sodium Fluoride/Potassium Oxalate should not be used as an anticoagulant with this device.

Specification

Measurement Technology	Oxidase Electrochemical Sensor
Measurement Calibration	Plasma
Sample	Capillary whole blood
Minimum Sample Volume	0.75 microliters
Measuring Range	10-600 mg/dL
Test Time	5 seconds
Memory Capacity	500 blood glucose test results with date and time
Power Saving	Turn off automatically 2 minutes after last user action Press the "⏻" button for 3 seconds.
Operating Temperature	50 ~ 104°F (10 ~ 40°C)
Operating Relative Humidity	10 - 90%

Specification















Hematocrit	30-60%
Power Supply	1 CR2032 battery
Meter Battery Life	About 1000 tests
Meter Dimension	98 mm x 45 mm x 16.5 mm
Meter Weight	55.0 ±5g with battery
Monitor	LCD display
Display Area	33.5 mm x 46 mm
Meter Storage Conditions	14 ~ 140°F (-10 ~ 60°C)
Test Strip Storage Conditions	39 ~ 86°F (4 ~ 30°C), < 90% relative humidity

50

Customer Service

We sincerely like to provide complete, considerate services to our customers. Please review all the instructions to make sure you are performing the steps correctly. If you have any questions or in case of problems with the **Rightest™** GM260 products, please contact your local Bionime customer service.

Description of used symbols

 IVD	For in vitro diagnostic use	 WEEE	 Manufacturer
 Consult the instruction for use		 Expiry date	
 Temperature limitation		 For single use only	
 CE 0197	CE-mark (with No. of notified body)	 EC REP	EC Representative
 STERILE	 R Method of sterilization using irradiation	 LOT	Lot number
 Caution (consult instructions for use and warnings)		 Biological risks	

51

Warranty

The manufacturer warrants that your **Rightest™** GM260 Meter will be free from defects in materials and workmanship for five years from the date of purchase.

This warranty does not apply to the performance of a **Rightest™** GM260 Meter that has been altered, misused, tampered with or abused in any way.

This warranty applies only to the original purchaser of the meter.

Please complete and return the enclosed warranty card to your local Bionime affiliate.

If the **Rightest™** GM260 Meter and strip are exposed to a high temperature difference, please wait 30 minutes before measurement.

NOTE

- During blood glucose measurement, the **Rightest™** GM260 Meter itself may come into contact with blood. Used **Rightest™** GM260 Meter therefore carry a risk of infection. Please dispose of your used **Rightest™** GM260 Meter after removing the battery-according to the regulations applicable in your country. For information about correct disposal, please contact your local council and authority.

Main Parts

Blood Glucose Meter, Test Strip, Control Solution

Manufacturer: Bionime Corporation

No. 100, Sec. 2, Daqing St., South Dist., Taichung City 40242, Taiwan

Product complied with In Vitro Diagnostic Medical Device Directive 98/79/EC. (CE0197)

EC-Rep: Bionime GmbH, Tramstrasse 16, 9442 Berneck / Switzerland

E-mail: info@bionime.ch

Lancing device

Manufacturer: Bionime Corporation

No. 100, Sec. 2, Daqing St., South Dist., Taichung City 40242, Taiwan

Product complied with Medical Device Directive 93/42/EEC

EC-Rep: Bionime GmbH, Tramstrasse 16, 9442 Berneck / Switzerland

E-mail: info@bionime.ch

Disposable Sterile Lancets

Manufacturer: SteriLance Medical (SuZhou) Inc.

No.68 LiTangHe RD, XiangCheng, SuZhou, JiangSu 215133, P.R. China

Product complied with Medical Device Directive 93/42/EEC. (CE0197)

EC- Rep: EMERGO EUROPE, Molenstraat 15, 2513 BH The Hague, The Netherlands